

Dimensions: mm (In.)

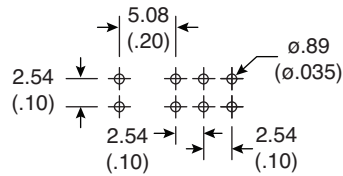
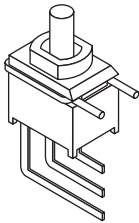
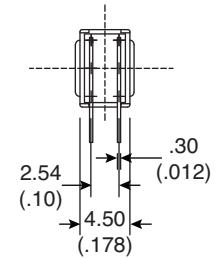
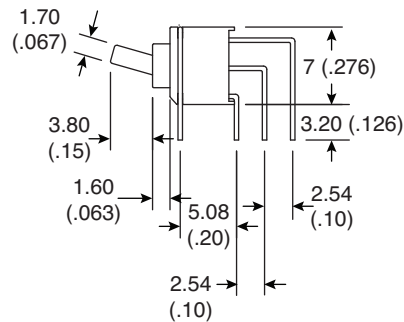
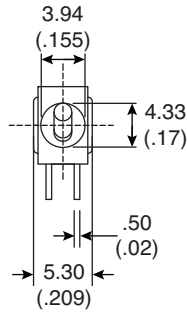

P.C. Mounting

POS.1	POS.2
ON	ON
2-3, 5-6	2-1, 5-4

Switch Function

**Electrical Specifications:**

- Contact resistance: Below 100mΩ typ. initial @ 2-4 V DC, 100mA
- Insulation resistance: 1,000MΩ min.
- Dielectric strength: 500 V RMS min. @sea level
- Rating: 0.4VA max. / 20VAC or DC max.

**Mechanical Specifications:**

- Mechanical life: 40,000 make-and-break cycles
- Operating temperature: -30°C ± 85°C

**Note:**

- RoHS Compliant

**Soldering Process:**

- Wave Soldering: Recommended Soldering Temperature: 260±5°C  
Duration of Solder Immersion: 5±1 seconds (PCB is 1.6mm in thickness)

Sealed Ultra-Miniature Toggle Switch  
108-2UD1T1768-EV

